

November 7, 2022 (Exhibit #1)

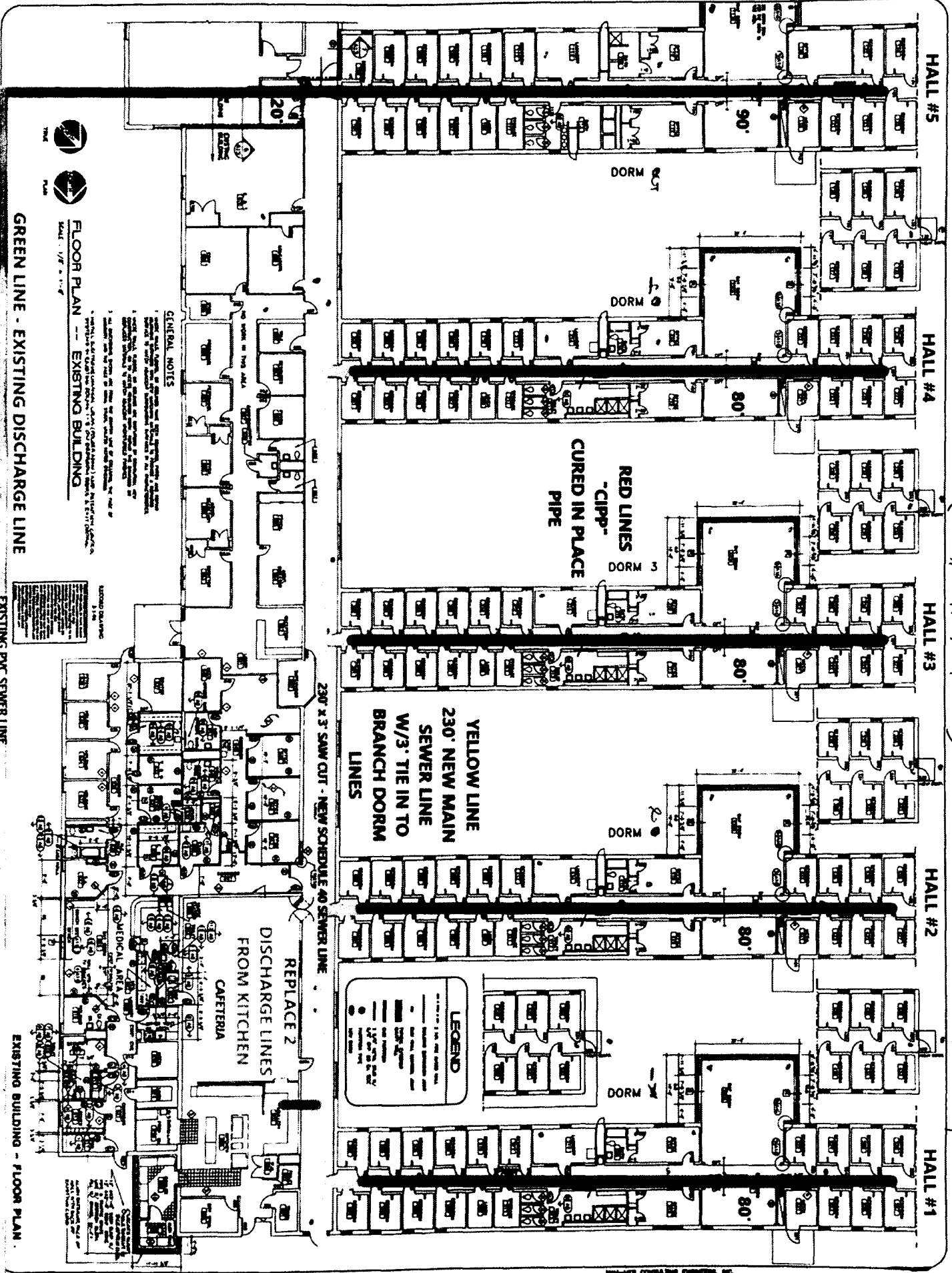

FLOOR PLAN  
EXISTING BUILDING  
SCALE: 1/8" = 1'-0"

GENERAL NOTES  
1. ALL WORK SHALL BE IN ACCORDANCE WITH THE LATEST EDITIONS OF THE INTERNATIONAL BUILDING CODES AND ALL APPLICABLE LOCAL ORDINANCES.  
2. THE CONTRACTOR SHALL BE RESPONSIBLE FOR OBTAINING ALL NECESSARY PERMITS AND APPROVALS FROM THE APPROPRIATE AGENCIES.  
3. THE CONTRACTOR SHALL MAINTAIN ACCESS TO ALL ADJACENT AREAS AND UTILITIES AT ALL TIMES.  
4. ALL WORK SHALL BE COMPLETED WITHIN THE SPECIFIED TIME FRAME.  
5. THE CONTRACTOR SHALL MAINTAIN CLEAR EGRESS PATHS AT ALL TIMES.

LEGEND

- EXISTING DISCHARGE LINE
- EXISTING PVC SEWER LINE
- NEW DISCHARGE LINE
- NEW PVC SEWER LINE

ADDITIONS AND RENOVATIONS  
BROWNWOOD, TEXAS

TEXAS YOUTH COMMISSION  
PROJECT NO. 0-170101

JESSEN  
ARCHITECTS & ENGINEERS, PC  
1000 WEST 10TH STREET  
DALLAS, TEXAS 75201  
TEL: 214-750-1000  
FAX: 214-750-1001  
WWW.JESSENARCHITECTS.COM

JESSEN

11/7/22



# ORIGINAL QUOTE

Remit To  
 PO Box 6347  
 Abilene, Tx 79608  
 Brownwood - 325-643-5215  
 Billing Questions - 325-695-3747

Estimate 49843963  
 Job 49674860  
 Estimate Date 12/21/2021  
 Technicians Eric Y. 34 - J  
 Justin P. 9

**Billing Address**  
 Rite of Passage-The Oaks  
 800 Farm to Market 45  
 Brownwood, TX 76801 USA

**Customer PO**  
  
**Job Address**  
 Rite of Passage-The Oaks  
 800 Farm to Market Road 3254  
 #Juvenile Center  
 Brownwood, TX 76801 USA

### Estimate Details

Rite of passage/The Oaks: Sewer line replacement

Task #	Description	Quantity	Your Price	Your Total
FR-PLUMB RES	Provide saw cut approx. 3' x 160'. Provide saw cut (5) areas approx. 3' x 5' area for dorms #1, 2, 3, 4 and 5 for tie in points for main line connections. Provide excavate approx. 160' of saw cut area. Provide tunnel under walls. Provided haul off of spoils. Provide demo and haul off of existing pipe in saw cut area. Provide and install approx. 160' of sch 40 pvc in saw cut area. Provide and install cast iron brass top clean outs at point of tie ons. Provided back fill with pea gravel. Provide concrete pour back. Provide permit and inspection with city of Brownwood. Not responsible for any plumbing past point of tie on, existing fixtures, private utilities, landscaping or any wall/floor/masonry/ceiling/carpentry repairs. If any additional work is needed additional charges will incur.	1.00	\$38,785.00	\$38,785.00

<b>Sub-Total</b>	\$38,785.00
<b>Tax</b>	\$0.00
<b>Total</b>	\$38,785.00
<b>Est. Financing</b>	\$814.49

TMPL - 18664 Darrin Black TEXAS STATE BOARD OF PLUMBING EXAMINERS 929 EAST 41 ST \* AUSTIN, TEXAS 78751 Phone# (512)936-5249

By signing I agree to the Terms and Conditions attached and hereby authorize Black Plumbing to begin work at Rite of Passage-The Oaks by Technician Justin P. 9 to perform work at time and material rate for all labor, material and equipment.

## Breakout of Attached Black Plumbing Bid

- a. Provide 230'x3' saw cut in hallway from exit door to hall 4  
*(This includes the original bid of the 160' saw cut and repair)*  
Provide excavate and haul off spoils. Provide tie in to existing cast iron at hall 4,3,2, and 1.  
Provide running new schedule 40 pvc line approx. 230'. Provide tie in to all branch lines up to 3' on all lines. Provide clean outs on all halls.
- b. Provide (2) 3" core drills accommodate 3 compartment sink and commercial dishwasher. Provide reworking drains under sink and dishwasher as needed and make tie in to new line under slab.  
*(This includes the original bid of the 160' saw cut and repair)*
- c. Provide back fill with pea gravel and pour back of concrete to grade.

d. Provide chain flail and jetting approx. 80' of 4" cast iron on **hall 1**.  
*If during cleaning process line is no longer a candidate extra charges will incur.*

e. Provide verification of all (5) reinstatements.

f. Provide installation of approx. 80' of 4" cipp. Provide proper cure time.

g. Provide (5) reinstatements.  
*If any reinstatements can not be made additional charges will incur.*

h. Provide chain flail and jetting approx. 80' of 4" cast iron on **hall 2**.  
*If during cleaning process line is no longer a candidate extra charges will incur.*

i. Provide verification of all (5) reinstatements.

j. Provide installation of approx. 80' of 4" cipp. Provide proper cure time.

k. Provide (5) reinstatements.  
*If any reinstatements can not be made additional charges will incur.*

l. Provide chain flail and jetting approx. 80' of 4" cast iron on **hall 3**.  
*If during cleaning process line is no longer a candidate extra charges will incur.*

m. Provide verification of all (5) reinstatements.

n. Provide installation of approx. 80' of 4" cipp. Provide proper cure time.

o. Provide (5) reinstatements.  
*If any reinstatements can not be made additional charges will incur.*

p. Provide chain flail and jetting approx. 80' of 4" cast iron on **hall 4**.  
*If during cleaning process line is no longer a candidate extra charges will incur.*

q. Provide verification of all (5) reinstatements.

r. Provide installation of approx. 80' of 4" cipp. Provide proper cure time.

s. Provide (5) reinstatements.  
If any reinstatements Provide chain flail and jetting approx. 80' of 4" cast iron on hall 1.  
*If during cleaning process line is no longer a candidate extra charges will incur.*

- t. Provide verification of all (5) reinstatements.
- u. Provide installation of approx. 80' of 4" cipp. Provide proper cure time.
- v. Provide (5) reinstatements.  
*If any reinstatements can not be made additional charges will incur. not be made additional charges will incur.*
- w. Provide 4'x4' saw cut at hall 5. Provide excavation and haul off of spoils. Provide removal of 4' of cast iron and install new clean outs after liner has been done. Provide back fill with pea gravel and pour back of concrete to grade.

x. Provide chain flail and jetting approx. 110' of 4" cast iron on hall 5.  
*If during cleaning process line is no longer a candidate extra charges will incur.*

y. Provide verification of all (6) reinstatements.

z. Provide installation of approx. 110' of 4" cipp. Provide proper cure time.

aa. Provide (6) reinstatements.

*If any reinstatements can not be made additional charges will incur.  
If concrete is thicker than 6" or core drills are deeper than 12" extra cost will incur.*

bb. Provide accessing walls as needed for core drills.  
*(Kitchen drain lines)*

Not responsible for any plumbing past point of tie on, existing fixtures, private utilities, landscaping or any wall/floor/masonry/ceiling/carpentry repairs. If any additional work is needed additional charges will incur.

Labor \$79,914.00

Material \$119,871.00

1.00 \$199,785.00 \$199,785.00



## NEW QUOTE INCLUDING WORK FROM ORIGINAL QUOTE

Remit To  
 Black Plumbing Services, LLC  
 PO Box 6347  
 Abilene, Tx 79608  
 Brownwood - 325-643-5215  
 Billing Questions - 325-695-3747

Estimate 70118244  
 Job 69963371  
 Estimate Date 10/28/2022  
 Technicians Justin P. 9  
 Zachery F. 27 - J

**Billing Address**  
 Rite of Passage-The Oaks  
 800 Farm to Market 45  
 Brownwood, TX 76801 USA

**Customer PO**  
  
**Job Address**  
 Rite of Passage-The Oaks  
 800 Farm to Market Road 3254  
 #Juvenile Center  
 Brownwood, TX 76801 USA

### Estimate Details

rite of passage: saw cut and cipp

Task #	Description	Quantity	Your Price	Your Total
FR-PLUMB COM	<p>Provide 230'x3' saw cut in hallway from exit door to hall 4 ( This includes the original bid of the 160' saw cut and repair) Provide excavate and haul off spoils. Provide tie in to existing cast iron at hall 4,3,2,and 1. Provide running new schedule 40 pvc line approx. 230'. Provide tie in to all branch lines up to 3' on all lines. Provide clean outs on all halls. Provide (2) 3" core drills ( This includes the original bid of the 160' saw cut and repair) accommodate 3 compartment sink and commercial dishwasher. Provide reworking drains under sink and dishwasher as needed and make tie in to new line under slab. Provide back fill with pea gravel and pour back of concrete to grade. Provide chain flail and jetting approx. 80' of 4" cast iron on hall 1, If during cleaning process line is no longer a candidate extra charges will incur. Provide verification of all (5) reinstatements. Provide installation of approx. 80' of 4" cipp. Provide proper cure time. Provide (5) reinstatements. if any reinstatements can not be made additional charges will incur.</p> <p>Provide chain flail and jetting approx. 80' of 4" cast iron on hall 2, If during cleaning process line is no longer a candidate extra charges will incur. Provide verification of all (5) reinstatements. Provide installation of approx. 80' of 4" cipp. Provide proper cure time. Provide (5) reinstatements. if any reinstatements can not be made additional charges will incur. Provide chain flail and jetting approx. 80' of 4" cast iron on hall 3, If during cleaning process line is no longer a candidate extra charges will incur. Provide verification of all (5) reinstatements. Provide installation of approx. 80' of 4" cipp. Provide proper cure time. Provide (5) reinstatements. if any reinstatements can not be made additional charges will incur. Provide chain flail and jetting approx. 80' of 4" cast iron on hall 4, If during cleaning process line is no longer a candidate extra charges will incur. Provide verification of all (5) reinstatements. Provide installation of approx. 80' of 4" cipp. Provide proper cure time. Provide (5) reinstatements. if any reinstatements can not be made additional charges will incur. not be made additional charges will incur.</p> <p>Provide 4'x4' saw cut at hall 5. Provide excavation and haul off of spoils. Provide removal of 4' of cast iron and install new clean outs after liner has been done. Provide back fill with pea gravel and pour back of concrete to grade. Provide chain flail and jetting approx. 110' of 4" cast iron on hall 5, If during cleaning process line is no longer a candidate extra charges will incur. Provide verification of all (6) reinstatements. Provide installation of approx. 110' of 4" cipp. Provide proper cure time. Provide (6) reinstatements. if any reinstatements can not be made additional charges will incur. If concrete is thicker than 6" or core drills are deeper than 12" extra cost will incur. Provide accessing walls as needed for core drills.</p> <p>Not responsible for any plumbing past point of tie on, existing fixtures, private utilities, landscaping or any wall/floor/masonry/ceiling/carpentry repairs. If any additional work is needed additional charges will incur.</p>	1.00	\$199,785.00	\$199,785.00
Labor \$79,914.00 Material \$119,871.00				

<b>Sub-Total</b>	\$199,785.00
<b>Tax</b>	\$0.00
<b>Total</b>	\$199,785.00
<b>Est. Financing</b>	\$2,637.16